



COMMUNITY ASSOCIATION

Architectural Control Committee
Plan and Specification Review Determination
PATIO, DECK, A/C, HOT TUB APPLICATION

(page 1 of 3)

ACC approval includes aesthetic features only and does not imply or warrant any structural integrity. This approval is not based on an engineering review of the site plan or structure. Please note: You may need the City of Mill Creek's permit and/or approval (425) 551-7254.

For MCCA Use Only

Submittal Number

16833

Date Submitted

8/31/2022

Please Attach
Color Samples
Here

Applications without
samples will not be
accepted.

Property owners
are responsible
for determining
all property lines,
locations, and
related
easements

Applicant Information

Name Sally WESLEY

Ph. 425 337 7411

Email

Site Information

Address 16312 18th AVE. S.E.

Division AMBERLEIGH

Lot # 35

Type of Structure

Patio[] Deck[] A/C Unit ☒ Hot tub[]

Est. Start Date: Sept.

Est. End Date:

You must attach a diagram, picture, or brochure of the proposed unit and show the exact location of the unit relative to your home and property lines.

Pursuant to the provision of Article VIII, paragraphs 8.1, 8.2, 8.2.1, 8.2.2, 8.2.3, 8.3, 8.3.1, 8.3.2, and 8.3.3 and Article IX of the Mill Creek Declaration of Covenants, the following determination by the Architectural Control Committee is hereby granted:

Approval subject to the following changes:

If visible from the street, owner agrees to enclose heat pump with short fence painted same color as the house.

Rejected for the following reasons:

(☒) Approve () Reject

[Signature] Date: 8/1/2022
Condominiums & Townhomes ACC or Board Approval

() Approve () Reject

Date:

MCCA Administration

(☒) Approve () Reject

[Signature] Date: 8/30/22
Chair, Architectural Control Committee

(X) Approve () Reject

Dawn Sabin Date: 9/7/2022

() Approve () Reject

Date:

() Approve () Reject

Date:

Application may be
mailed, emailed
(info@mcca.info), or
dropped off at the MCCA
Office (15524 Country
Club Dr, Mill Creek, WA
98012)

01-May-19



Architectural Control Committee

Plan and Specification Review Determination

PATIO, DECK, A/C, HOT TUB APPLICATION (page 2 of 3)

IMPORTANT: Include a sketch of the proposed fencing describing location on the property, dimensions and style (see item #1 of "Basic Policy for Additional Construction" on page 3). Attach additional sheets if needed.

Proposed Construction/Location
Drawing (Property sketch):

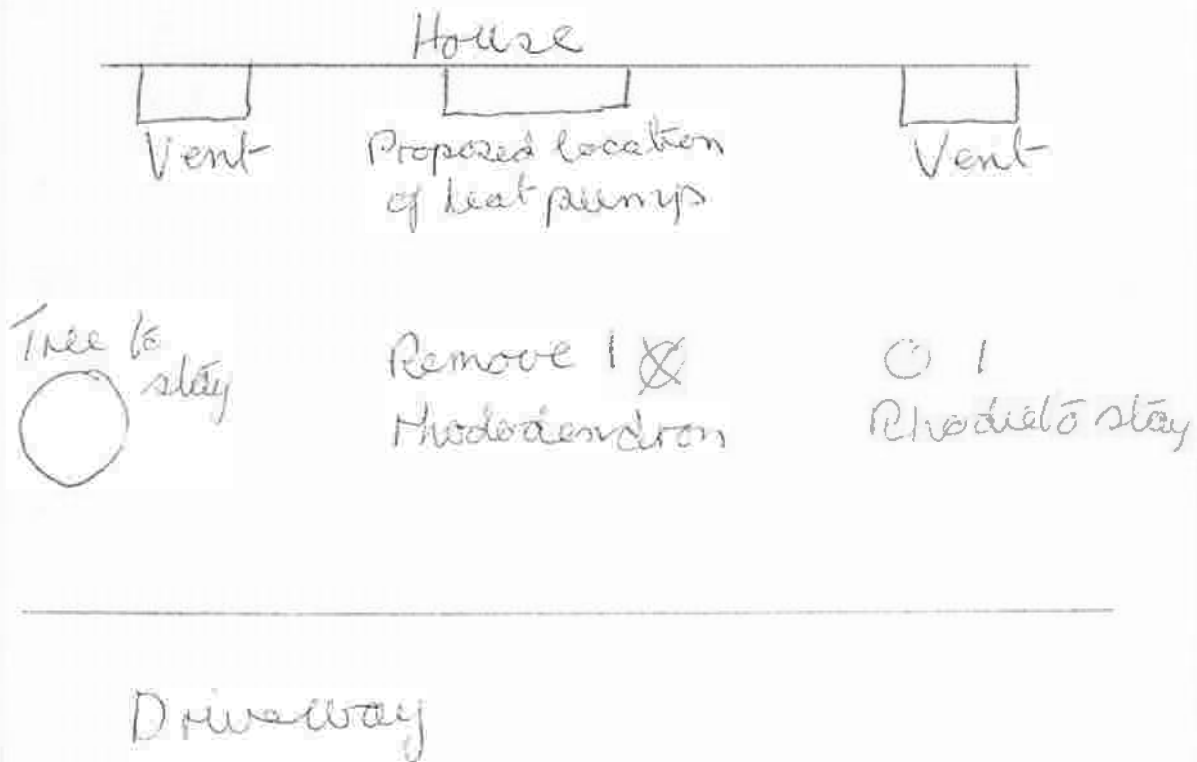



Architectural Control Committee

Plan and Specification Review Determination

PATIO, DECK, A/C, HOT TUB APPLICATION (page 3 of 3)

Basic Policy for Additional Construction

****ALSO SEE THE ACC GUIDELINES****

Any additional construction upon a building site must be submitted to and approved by the Architectural Control Committee prior to commencement. In the event approval has not been received, a "Stop Work Order" will be issued until such time as the property paperwork has been received and processed by the MCCA office. As part of the submittal procedure, the following information must be furnished to the ACC before the submittal is acted on:

1. Detailed information, written or printed, on type of addition that is planned for the site. This information should include exact location, finished dimensions, color, style, materials, etc.
2. An elevation drawing or a perspective drawing of the proposed additional construction sufficiently detailed to show the appearance of the addition and its relationship to the existing structure.
3. A sketch of the property showing the relationship between the proposed addition and all other adjacent structures. It is the homeowner's responsibility to locate and identify all property markers, both at the site and on the sketch included with the submittal.
4. As a matter of record, a projected completion date is requested by the owner. If any extension of the completion date is necessary, or the project is canceled/postponed, the Association Office should be notified.
5. Approved plans are subject to final inspection if deemed necessary by the Committee. All plans become the property of the Association and will be filed in the lot file. In case of changes, plans should be resubmitted to the Committee prior to construction. Variance from approved plans may be subject to change at the homeowner's expense or removal at the discretion of the Committee.

This signature verifies that the applicant has reviewed the above policy and agrees to abide by all guidelines and terms of approval set forth on the application attached. Signature also implies "Right of Entry" for members of the ACC for the purpose of plan review.

Applicant Signature

Date

☐ Owner Requests ACC Members Call Before Entering Property For Review (discuss specifics of project, pet in yard, children at home alone, etc.)

Outdoor Unit Single Zone Heat Pump Ductless System

Outdoor Model:

38MARBQ36AA3



Submittal Data

Turn to the experts

Job Data: 7.63.22 1015 1015 1015

Location: side of house

Buyer: Wesley Buyer P.O.#:

Carrier #:

Unit Number:

Model Number: 38M

Performance Data Certified By: CH

Date: 8-25-22

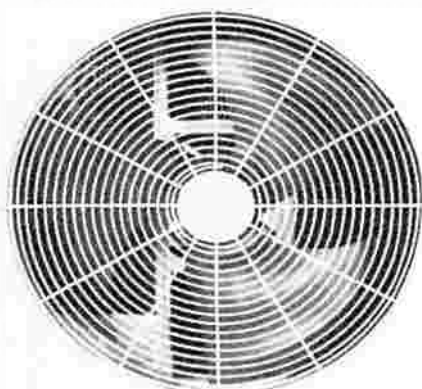

STANDARD FEATURES

- Variable Speed (Inverter)
- Factory installed Base Pan Heater
- Factory installed Crankcase Heater
- Low Voltage Controls
- Auto-Restart function
- Condenser High Temp Protection
- Modes: Cool, Heat, Dry, Fan, Auto
- Quiet operation
- Anti-corrosive fin coating

LIMITED WARRANTY*

- 10 year limited to original purchaser on compressor and parts upon timely registration, otherwise 5 years
- *For residential applications.
- See warranty for full details.

NOTE: Images for illustration purposes only. Actual models may be slightly different.

System	Size		36
	Outdoor Model		38MARBQ36AA3
Electrical	Voltage, Phase, Cycle	V/Ph/Hz	208/230-1-60
	MCA	A	28
	MOCP-Fuse Rating	A	35
Operating Range	Cooling Outdoor DB Min - Max	°F(°C)	-22-122 (-30-50)
	Heating Outdoor DB Min - Max	°F(°C)	-22-86 (-30-30)
Piping	Total Piping Length	ft (m)	213 (65)
	Piping Lift	ft (m)	98 (30)
	Pipe Connection Size - Liquid	in (mm)	3/8 (9.52)
	Pipe Connection Size - Suction	in (mm)	5/8 (16)
Refrigerant	Refrigerant Type		R410A
	Metering Device		EEV
	Charge	lbs (kg)	7.50 (3.40)

* Condensing unit above or below indoor unit
For Compatibility See Product Data

Outdoor Coil	Face Area	Sq.Ft.	24.0
	No. Rows		3
	Fins per Inch		18
	Circuits		6
Compressor	Type		Rotary Inverter
	Model		KTF250D22UMT
	Oil Type		VG74
	Oil Charge	Fl. Oz.	22.7
Outdoor	Rated Current	RLA	18.0
	Unit Width	in (mm)	37.24 (946)
	Unit Height	in (mm)	34.84 (885)
	Unit Depth	in (mm)	16.14 (410)
	Net Weight	lbs (kg)	150.13 (68.1)
	Airflow	CFM	2,235
	Sound Pressure	dB(A)	61.5

(High 4.5A)